

# Orchard Valley in Traditional Collection

## Modular Home Floor Plan

1,390 Square Feet

3 Bedrooms

2 Bath

Building Footprint: 49-11 x 41-4

Simple Lines create an understated sophistication. The open living areas make the home feel spacious and encourages casual get-togethers. A door in the dining area provides convenient access to the backyard for outdoor grilling. Separated from the secondary bedrooms, the master suite offers a quiet place to take a relaxing bath or a nap.



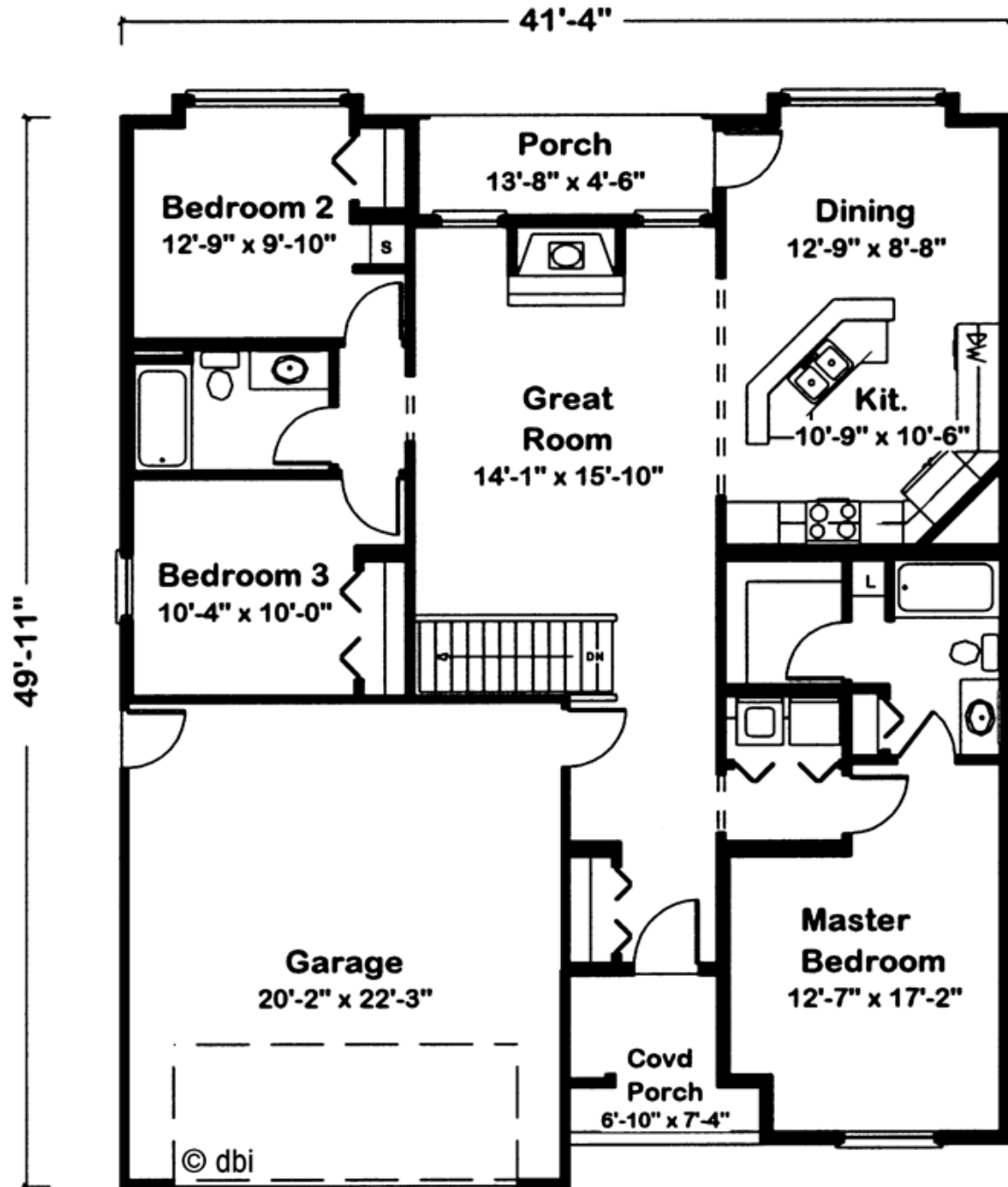

1st Floor Plan

Call Catskills Modular Homes to Discuss Your New Modular Home

845-988-9637